

RESIDENCE 04C

INTERIOR	EXTERIOR
7,744 F ²	1,607 F ²
720 M ²	150 M ²

TOTAL
9,351 F²
870 M²

*

- 5 BEDROOMS
- 6 BATHROOMS
- 2 POWDER ROOMS
- FAMILY ROOM
- SERVICE SUITE
- WINE ROOM
- EXERCISE ROOM
- DEN
- GREAT ROOM

OCEAN VIEW

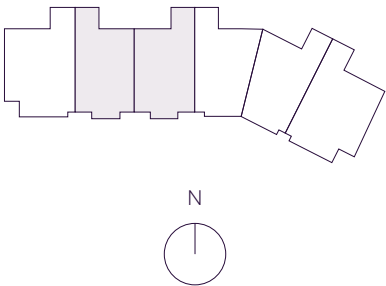

THE RESIDENCES
SIX FISHER ISLAND
⑥

6 Fisher Island Drive, Fisher Island, FL 33109
305.873.3852 — 6-fisherisland.com

DouglasElliman
Development Marketing

The dimensions stated for this floor plan are approximate because there are various recognized methods for calculating the square footage of a unit. The square footage stated here is calculated from the exterior boundaries of the exterior walls to the centerline of interior demising walls without deductions for cutouts, curves, or architectural features. This method typically results in quoted dimensions greater than the dimensions that would be determined by using other accepted methods. The definition of "Unit" and the calculation method to be relied upon is set forth by the Developer in Developer's prospectus which method may result in a square footage calculation less than the result of the calculation method used here. Dimension and unit configuration is not guaranteed and may change during construction. Depictions of furnishings, fixtures and other items of personal property are not included with purchase. Consult the Developer's prospectus to understand Unit dimensions, to learn what is included with purchase and by payment of regular condominium assessments, and to learn all terms and conditions. 2023 © PRH Parcel 7 Owner, LLC, with all rights reserved.

- PRIMARY BEDROOM
23'-1" x 19'-4"
- BALCONY
15' x 67'-11"
- FAMILY ROOM
22'-8" x 19'
- GREAT ROOM
29'-7" x 50'-7"
- HER BATHROOM
18'-5" x 15'-1"
- KITCHEN
12'-10" x 17'-8"
- HER WARDROBE
17'-5" x 14'-4"
- HIS BATHROOM
12'-6" x 14'-9"
- WINE ROOM
6'-3" x 14'-5"
- HIS WARDROBE
14'-10" x 19'-8"
- EXERCISE ROOM
12'-3" x 26'-8"
- BEDROOM 2
16'-1" x 13'-8"
- BEDROOM 3
14'-8" x 12'-10"
- BEDROOM 4
14'-8" x 12'-10"
- BEDROOM 5
16'-9" x 13'
- DEN
11'-9" x 11'-3"
- BALCONY
76'-9" x 13'-8"



N 25° 45.8255



*

W 80° 8.4428